

**RACK.N2.600.HP.D**
RACK.ZN2.600.HP.D
RACK.N2.1000.HP.D

N2 GENERATOR RACK

The MicroPROGEL High Purity (HP) Nitrogen Generators are engineered to transform standard compressed air in to a safe regulated supply of 99.9995% pure nitrogen. Typical applications include GC make up gas and carrier gas, including ECD (Electron Capture Detector), solvent evaporation, DSC (Differential Scanning Calorimeter) and virtually any analytical instrument that requires a small flow of ultra high purity nitrogen.

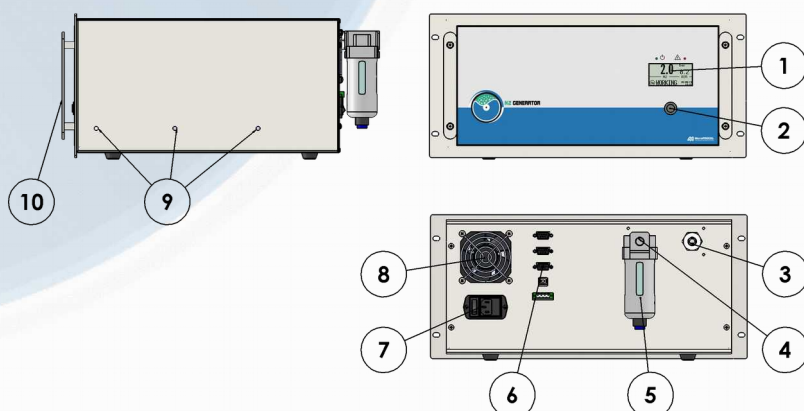

- 1 Display LCD touch-screen
- 2 START/STOP button
- 3 Air compress inlet
- 4 Nitrogen outlet
- 5 Filter
- 6 I/O ports: RS485 – RS232 – USB - Digital I/O
- 7 Power supply switch
- 8 Fan
- 9 Predispositions for sliding rail
- 10 Front handles

Main applications

- Produces a supply of high purity Nitrogen 99.9995% for GC application
- TOC applications including combustion, UV persulfate and wet oxidation sampling techniques
- make-up and carrier gas applications including ECD

Main advantages

- Generates Nitrogen on demand from external compressed air
- Designed to run 24 hours a day
- Eliminates dangerous Nitrogen cylinders from the laboratory
- The ZN2 series is equipped with a Catalyst oven to remove Hydrocarbons (as methane)
- Smart control of the flow of inlet air, it is function of the real flow of nitrogen used by the application
- Minimum maintenance with an annual filter change
- USB/RS232 ports to remote the system anywhere in the world
- Low power, low noise, low maintenance
- Ultra fast start-up time
- Fast purity (10 ppm in less than 3 hours)

Technical Specifications

Model	N2.600.HP.D	ZN2.600.HP.D	N2.1000.HP.D
N2 outlet			
Flow rate (max)	600 cc/min		1000 cc/min
Outlet pressure (min)	1.0 bars		
Outlet pressure (max)	Inlet pressure – 2.0 bar		
Nitrogen purity	>99.9995% - (<5ppm O2 @ 7 Bar inlet pressure)		
O2 content	-	< 5 ppm	-
Hydrocarbon content (CH4 free)	-	< 0.05 ppm	-
Air inlet			
Air inlet requirement	Particulate: <1 micron		
	Dewpoint: -40°C (-40°F)		
	Oil <0.01 mg/m ³		
Flow rate (max)	12 l/min	15 l/min	
Min supply pressure	7 bars		
Max supply pressure	10 bars		
Min temperature	1°C (34°F)		
Max temperature	35°C(95°F)		
Communication			
LCD with touch screen	Yes	Yes	Yes
RS232		X	
RS485		X	
USB		X	
General data			
Supply rating	100-240Vac 50/60Hz – 2A		
Connection type	IEC320-C13		
Installation power (max)	240W (280VA)		
Fuse rating	4A -240Vac (5x20mm)		
Net weight	<25 kg		
Dimensions	Standard 19" Rack 5U – deep 48 cm		
Connections			
Outlet port	1/4" female		
Inlet port	1/4" female		
Operating conditions			
Temperature	5-35°C (41-95°F)		
Humidity (max, non condensing)	80% at 25°C (77°F)		
Noise	<25dB(A)		
IP rating	IP20		
Pollution degree rating	2 (with no aromatic compounds)		
Altitude	< 2000m		